

# Sustainable Success Stories

## *Sunset Drive Office Building*

*111 S. Cherry St., Olathe, Kan.*

### Goal:

The Johnson County Sunset Building was designed to exist in harmony with its site, its neighbors and the environment. Designs promote the health of its occupants and the good of the community.

### Project Description:

The Sunset Building is a 129,000 square foot building that embraces its environmental surroundings to create a striking workplace that transcends a typical office. The facility houses six county departments and agencies previously dispersed among leased office spaces and other county buildings. The building is located on Sunset Drive, an area focused on conservation and protection of natural water resources.

### Community Benefits and Lessons Learned:

Education about advocacy for environmental issues are core initiatives of the Sunset Drive Office Building. Through aggressive outreach initiatives, the project continues to make the point that being environmentally sustainable with capital development is the only logical and economically responsible approach to take.

Throughout this project the county worked in close collaboration with the media to educate them and seek attention for the project. More than 5,000 individuals have toured the building including visitors from as far as Durham, North Carolina who studied the approach to environmentally responsible construction. Educational signage is posted throughout the building marking key environmental features.

### Funding Sources and Partnerships:

Johnson County, Kansas  
Design-Build Team

### Contact:

Johnson County Government  
111 S. Cherry St.  
Olathe, KS 66061  
(913) 715-1146



*The outside of the Sunset Building with natural water features.*

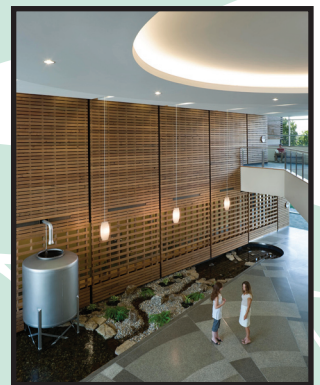

*A biogarden is featured inside the building.*



*Natural light creates a comfortable, healthy environment for employees.*