

Directions to Metropolitan Community College Business and Technology Center

1775 Universal, Kansas City, Mo.

The Mid-America Regional Council will be renovating its offices and the building owner will be adding on to the parking structure. Starting Oct. 1 many MARC meetings will be held at the BTC location due to construction at Rivergate Center. We appreciate your patience as we renovate the MARC offices and parking.



BTC West Lobby entrance, south parking lot

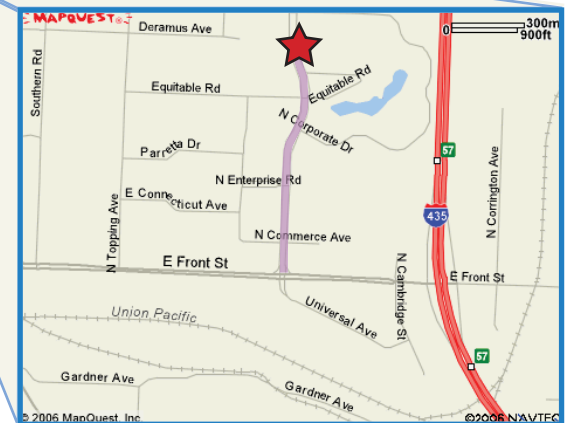

Directions

From MARC or I-35 North*:

- ◆ Take I-35 North to the Front Street exit.
- ◆ Take a right on Front Street and head east.
- ◆ Turn left on Universal Ave. into the business park.
- ◆ Turn right on the second unnamed street after Equitable.
- ◆ Enter the BTC West Lobby entrance from the south parking lot.

From I-435 on the Missouri side:

- ◆ Take the Front Street exit.
- ◆ Head west on Front Street.
- ◆ Turn right on Universal Ave. into the business park.
- ◆ Turn right on the second unnamed street after Equitable.
- ◆ Enter the BTC West Lobby entrance from the south parking lot.

*All northbound lanes of I-35 between I-670 and the I-70 viaduct are closed through Dec. for repairs. Detours are marked. Please allow extra time for delays.

**Metro Bus Route 126 stops at the Business & Tech Center.
Transit times can be found at www.kcata.org.**



MAIN OFFICES: 600 BROADWAY, SUITE 300
KANSAS CITY, MISSOURI · 64105
816/474-4240 · WWW.MARC.ORG

Interior Map of Meeting Space

Second Floor of Business and Technology Center

Enter the BTC West Lobby entrance from the south parking lot. Proceed up the stairway in front of you. All of MARC's reserved meeting and conference rooms are on the second floor (shaded in blue below). If you need more information or assistance, or have special needs, please call the MARC offices at 816/474-4240.

Meeting rooms 2076, 2077, 2080, 2082:

At the top of the stairs turn right, take another sharp right and walk through the break area. Turn left. The meeting rooms will be toward the end of the hallway.

Conference room 2003:

At the top of the stairs turn right, take another sharp right and walk through the break area. Turn right. The room is on your left.

Conference room 248 or 249:

At the top of the stairs turn right and proceed down the hallway past the fitness center. The rooms will be on your left.

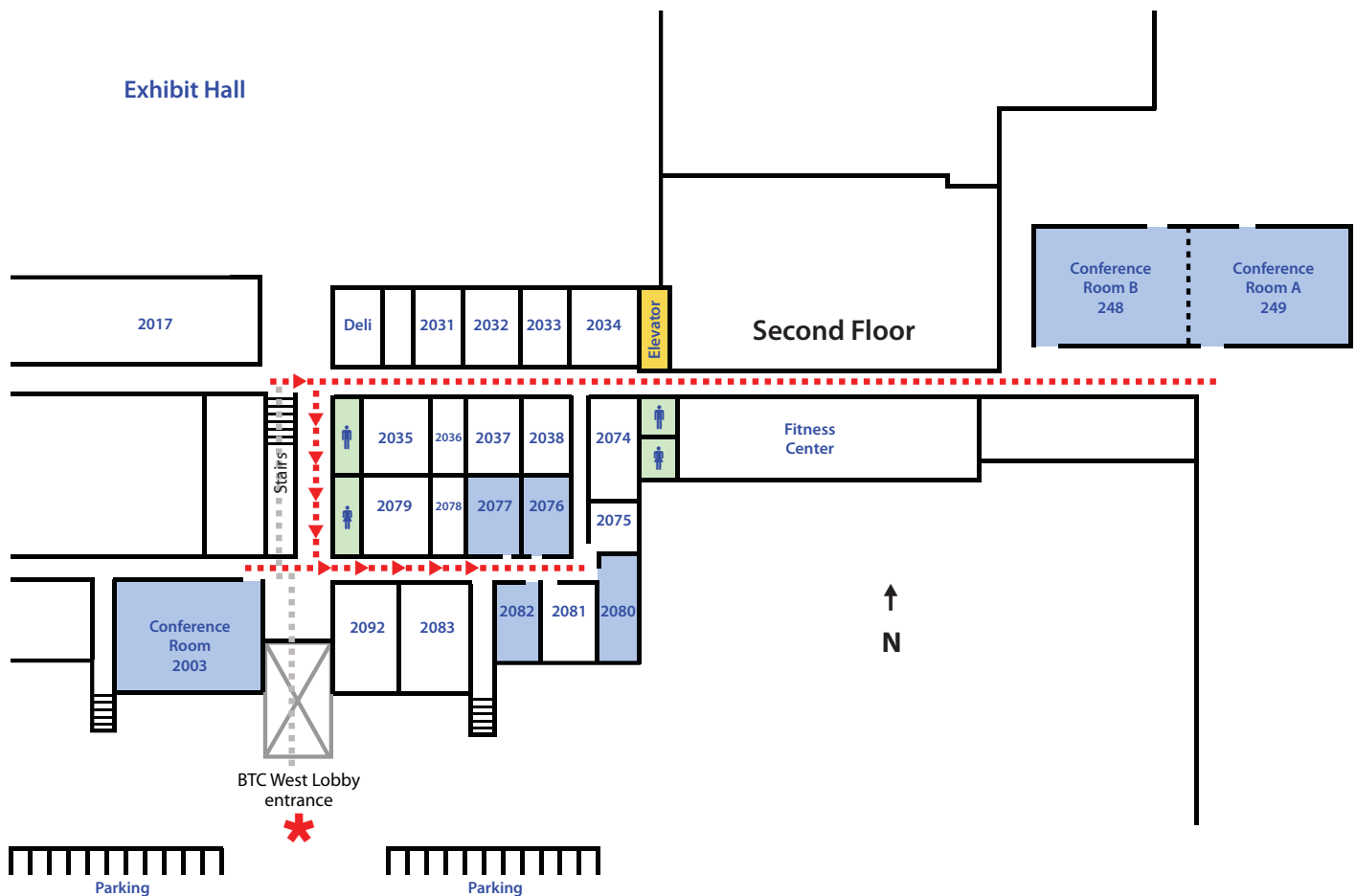

MAIN OFFICES: 600 BROADWAY, SUITE 300
KANSAS CITY, MISSOURI · 64105
816/474-4240 · WWW.MARC.ORG